

SmartPly[®] Hoarding

The Smart Answer for Site Hoarding

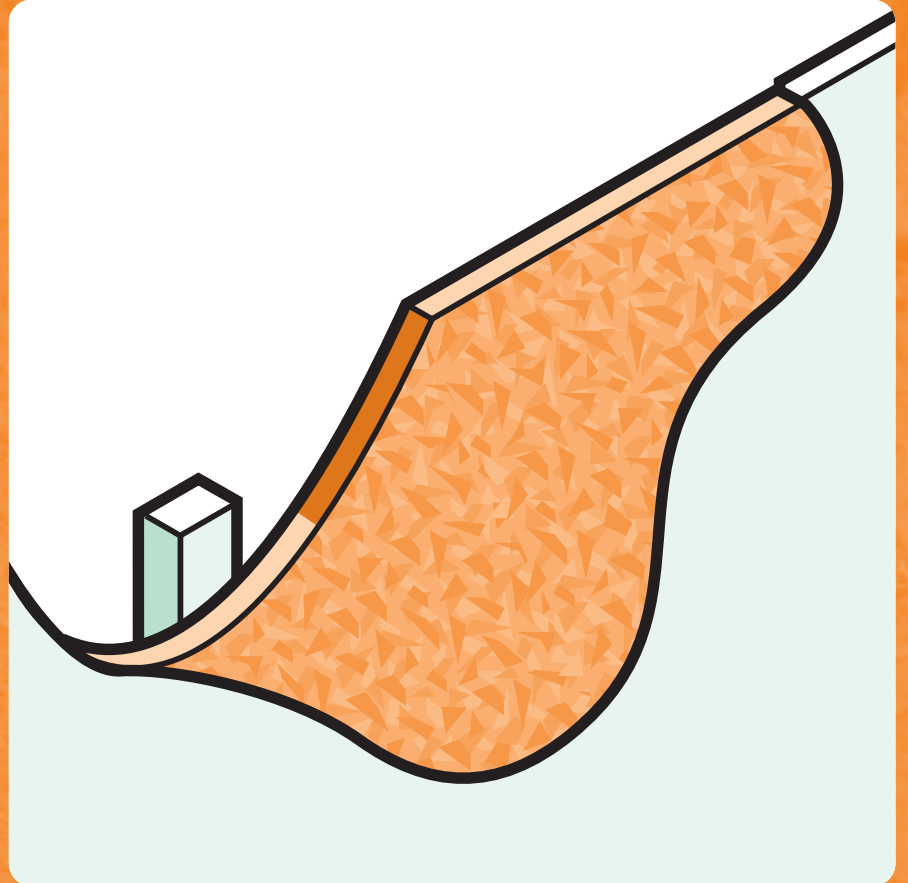

designed for use in a variety of
hoarding applications and available in
a variety of thicknesses, dimensions
and different grades



smart hoarding

SmartPly have developed a range of cost effective site hoarding products designed to suit individual requirements, from disposable temporary hoarding to durable, re-usable high profile applications.

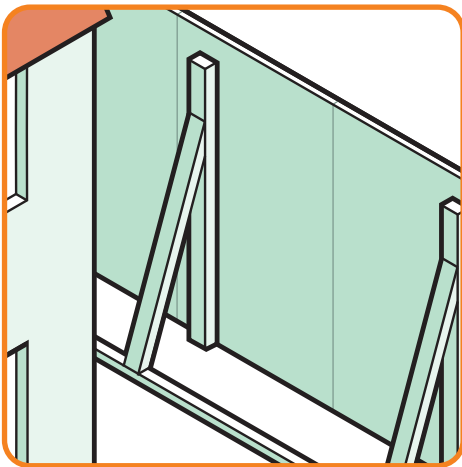

defect free and easy-to-use

SmartPly has no structural defects, such as knotholes and core voids, and is easy to work with. It cuts easily, will not delaminate, and can be bored, routed and planed with consistent results. Panels can be nailed 10mm from the edge without splitting or breaking out – critical to structural applications.

smarter, easier hoarding

SmartPly engineered OSB2 and OSB3 hoarding boards, when constructed on a timber framework support, have superior strength and stiffness to provide a long lasting and robust barrier to the enclosure.

zero-added formaldehyde

In keeping with current construction methods of working towards healthier homes, all SmartPly 3 products have been manufactured using zero-added formaldehyde.

smarter products – higher standards

All SmartPly products are manufactured to EN 300 from a structural panel that satisfies standards BS 5268 Part 2, and is approved by the British Board of Agrément (BBA) and the Irish Agrément Board (IAB). Its suitability for structural use is also recognised by Homebond, Local Authority Building Inspectors and the NHBC.

All SmartPly OSB products are compliant with the Construction Products Directive (CPD) for structural use. Every board of SmartPly 3 is marked CE 2+ structural. SmartPly has achieved I.S. EN ISO9001: 2000, the internationally recognised quality management system.

environmentally approved

At least 90% of the timber used in the manufacture of SmartPly comes from well-managed forests, independently certified according to the rules of the Forest Stewardship Council (FSC). All SmartPly 3 products are made with formaldehyde-free resins.

typical SmartPly hoarding erection specification (system A)

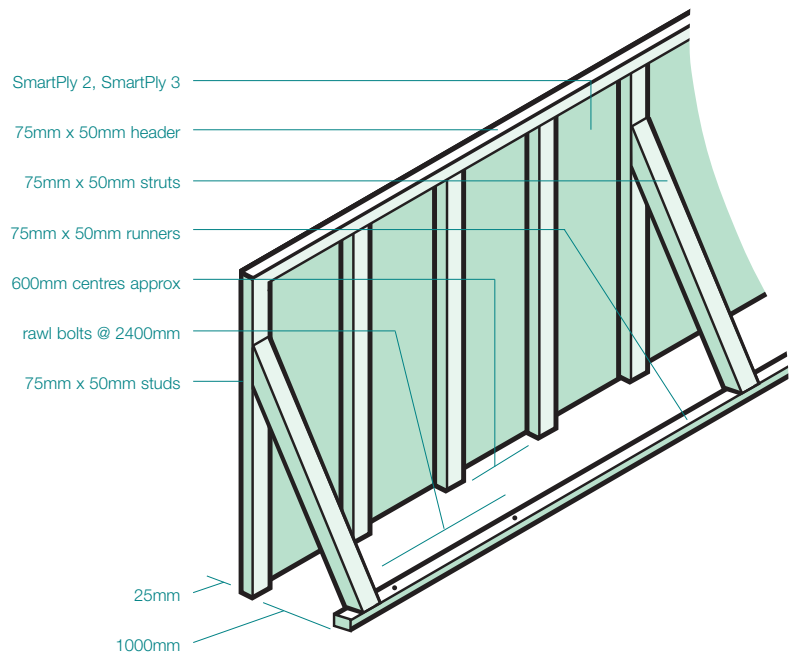

selecting the correct SmartPly hoarding

application	product
Temporary or disposable hoarding/boarding, no requirement for re-use	SmartPly 2
Durable hoarding/boarding, requirement for re-use	SmartPly 3

dimensions and thickness (mm)			
thickness	length x width	type	grades
11	2440 x 1220	square edge	OSB2/OSB3
15	2440 x 1220	square edge	OSB2/OSB3
18	2440 x 1220	square edge	OSB2/OSB3

Note: Tongue & grooved panels may also be available on request.

storage and handling

Careful storage and handling is important to maintain panels in their correct condition for use. Boards should be stacked flat, off the ground and on a level surface with all four edges flush. Stacking on the edge should be avoided. Wherever possible, panels should be stored in an enclosed dry building, protected from rain and accidental wetting.

Stack on battens of equal thickness at centres not exceeding 600mm (as per recommendations of BS 7916). Care should be taken to avoid damage from banding. Bands should be cut as soon as practical to avoid permanently deforming the boards. During transport it is particularly important to protect edges and corners with suitable coverings.

typical SmartPly hoarding erection specification (system B)

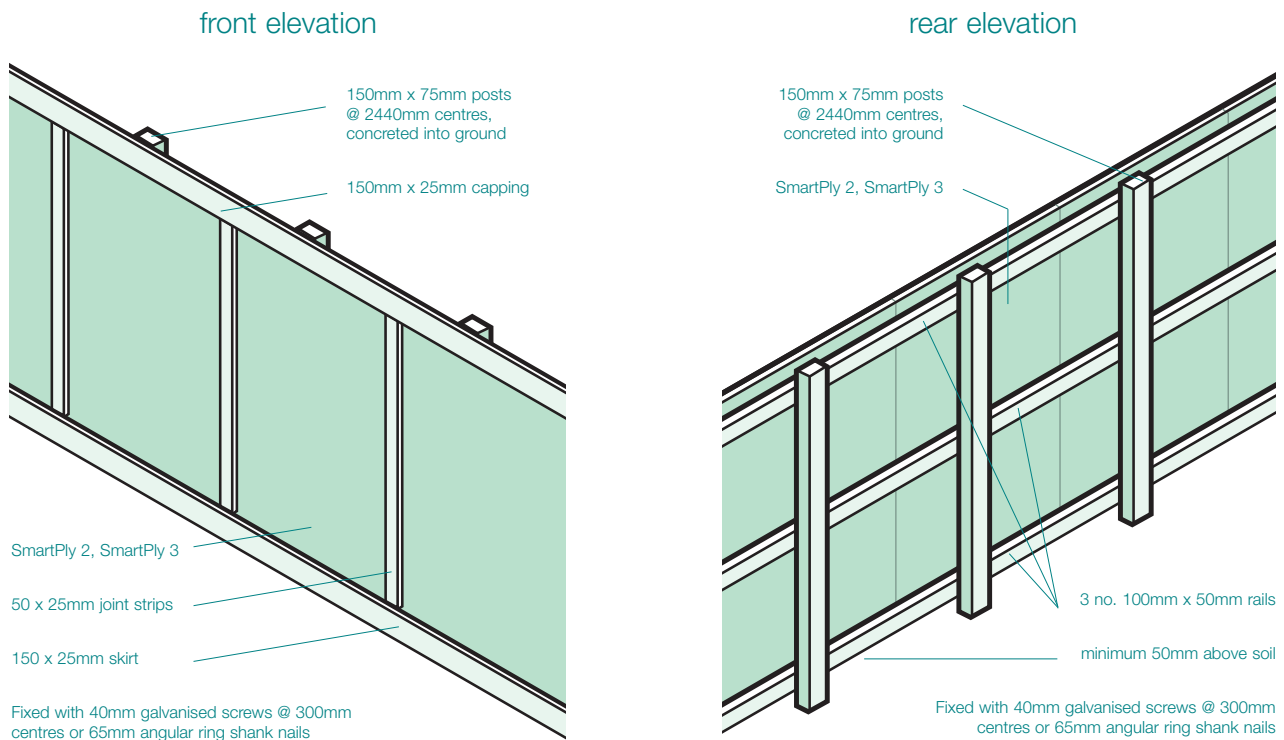

Note: 3 rails shown in diagram, however 4 rails may be required.

fixings and expansion gaps

As no two projects are alike, it is inappropriate to suggest one particular installation method. SmartPly Europe recommends that your engineer designs the frame. However, some considerations when erecting site hoarding supports include:

- ✓ site location (major/minor thoroughfare)
- ✓ ground conditions (concrete, tarmac, soil)
- ✓ wind speed
- ✓ wind direction
- ✓ duration

complete protection

SmartPly Europe recommend users:

- seal edges with primer and/or topcoat fixing holes treated with putty
- leave 3mm expansion gap between panels to counter potential differential movement (due to differing climactic conditions). Where the fence is to abut a rigid upstand or a wall a gap of 10mm should be allowed.

Note: It is the specifier's/user's responsibility to ensure that all hoarding and supporting framework meets structural requirements.

Using any reputable paint system, SmartPly offers an excellent finish that caters for most site conditions.

The durability of the panel, is to a large degree, dependant upon the treatment it receives in terms of finishing. This basically means that you can achieve the desired performance required in terms of price, maintenance, aesthetics and life-expectancy based on the quality of paint finish applied.

It is recommended that users consult a technical engineer should a more detailed specification be required.



hoarding solutions

SmartPly OSB comprises of a range of products developed specifically for use in combination with a timber framework, as a secure barrier for construction and temporary works to help prevent towards unauthorized access.

SmartPly 2 and SmartPly 3 hoarding boards, when constructed on a timber framework support, have superior strength and stiffness to provide a long lasting and robust barrier to the enclosure.



SmartPly 3

Conditioned to perform in humid environments, SmartPly 3 is the fully certified alternative to softwood plywood.

It is versatile, strong and cost-effective. Manufactured with exterior resins, SmartPly 3 is suitable for both interior and exterior structural applications.

SmartPly 2

SmartPly 2 is a versatile, strong and cost-effective board, manufactured to EN 300 standard. It is recommended for general non-structural building purposes and structural applications in dry conditions.

It is ideal for applications such as general hoarding and boarding, signboards, packaging, furniture, pallet tops, temporary formwork, garden sheds and many others.

how do I recognise the product?

All SmartPly 3 structural panels are clearly marked with the following information:*

- ☑ **manufacturer's name (SmartPly Europe)**
- ☑ **European norm (EN 300 standard)**
- ☑ **type/grade of board**
- ☑ **nominal thickness**
- ☑ **major axis (direction of laying arrows)**
- ☑ **batch number or production week and year, day/shift**
- ☑ **certification mark (e.g. BBA, IAB)**
- ☑ **CE 2+ structural certification**
- ☑ **FSC certification**

* Markings may vary depending on product type

smart quality

certification

SmartPly structural panels meet EN 300, BS 5268 Part 2, and are certified by the British Board of Agrément (BBA), Irish Agrément Board (IAB) and other European certifying bodies. This product is suitable for residential and commercial construction, including prefabricated and modular home applications.

All SmartPly OSB products are compliant with the Construction Products Directive (CPD) for structural use. Every board of SmartPly 3 is marked CE 2+ structural. SmartPly has achieved I.S. EN ISO9001:2000, the internationally recognised quality management system.

SmartPly structural panels can be used for structural applications in humid environments (including kitchens and bathrooms) as defined within the terms of Service Class 2 on ENV 1995-1-1 for load-bearing boards. Also suitable for domestic use as defined in BS 6399 Part 1 for dead and imposed loads for designed joist spacings not exceeding 600mm centres (for 15mm) providing they are in accordance with IAB Certificate No. 02/0093 or BBA Certificate No. 98/3488/C.



SmartPly has full certification from the Forestry Stewardship Council, one of the largest and most credible certifiers of wood producers and has the support of major environmental groups (such as World Wildlife Fund, Greenpeace, and the Rainforest Action Network) as well as key inter-governmental forestry bodies. The FSC certification is the leading internationally-recognised standard that assures buyers of wood-based products that the timber used results from environmentally and socially responsible forestry management.



By buying products with the FSC label you are supporting the growth of responsible forest management worldwide

FSC Supplier Cert no. TF-COC-1572
© 1996 Forestry Stewardship Council A.C.

For more information about any SmartPly product, contact your local merchant.

SmartPly Europe Ltd
Belview
Slieverue
Waterford
Ireland
T: +353 (0)51 851233
F: +353 (0)51 851130

SmartPly Europe Ltd
Hawley Manor
Hawley Road
Dartford Kent DA11PX
United Kingdom
T: +44 (0)1322 424900
F: +44 (0)1322 424920

www.smartply.com info@smartply.com

This document is printed on matt uncoated paper, ECF, acid free, recyclable and biodegradable.